

**Back-UPS™  
RS 500**

**User's Manual**

990-9217A-001 12/03

**Connect the Internal Battery**

The Back-UPS RS is shipped with one battery wire disconnected. To connect the internal battery, proceed as follows:

**Note:** Connecting the battery is a safe procedure. However, small sparks may occur during the process. This is normal.

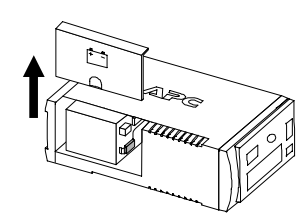
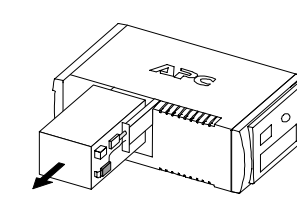
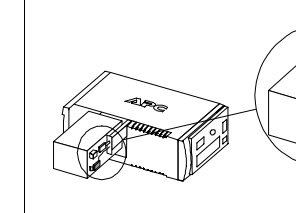
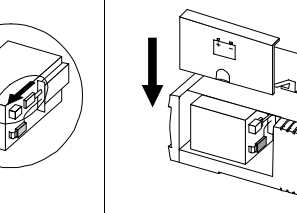
<p><b>1</b></p>  <p>Place the unit on its side. Slide the battery compartment cover upward and off of the UPS.</p>	<p><b>2</b></p>  <p>Pull the battery partially out of the chassis, exposing the battery terminals and wires.</p>	<p><b>3</b></p>  <p>Connect the black battery wire to the terminals as Ground (-) terminal. Slide the battery back into the chassis.</p>	<p><b>4</b></p>  <p>Align the battery compartment cover with the grooves in the Back-UPS RS. Slide the cover down until it locks.</p>
---	--	---	--

**Installation**

**1 Placement / Power**

Avoid placing the Back-UPS RS in:

- Direct sunlight
- Excessive heat
- Excessive humidity or in contact with fluids of any type

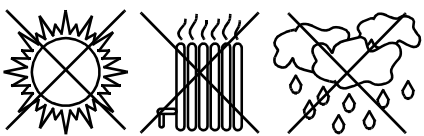

Plug the Back-UPS RS into a wall outlet, as shown.

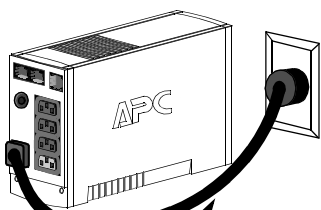

Your computer's power cord.

- The Back-UPS RS charges the internal battery any time it is connected to a wall outlet.

**2 Connect Equipment to the Back-UPS RS**

The rear panel of the Back-UPS RS consists of the following elements:

**Battery Back Up Outlets (qty. of 3).** These outlets provide battery back-up, surge protection, and Electromagnetic Interference (EMI) filtering. In case of power outage, battery power is automatically provided to these outlets. Power (utility or battery) is not supplied to these outlets when the Back-UPS RS is switched **Off**. Connect a computer, monitor, and external disk or CD-ROM drive to these outlets.

**Surge Only Outlet.** This outlet is always **On** (when utility power is available) and is not controlled by the **On/Off** switch. This outlet does not provide power during a power outage. Connect a printer, fax machine or scanner to this outlet.

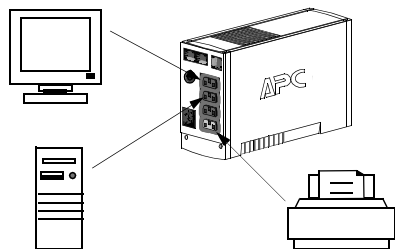

**3 Connect Phone Lines to Surge Protection**

The telephone ports provide lightning surge protection for any device connected to the telephone line (computer, modem, fax or telephone). The telephone ports are compatible with Home Phonetone Networking Alliance (HPNA) and Digital Subscriber Line (DSL) standards, as well as all modem data rates. Connect as shown.

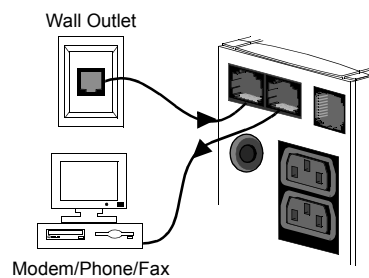

**4 Switch on the Back-UPS RS**

**Note:** Allow the Back-UPS RS to charge a full eight hours prior to use.

Press the push-button on the front panel of the Back-UPS RS.

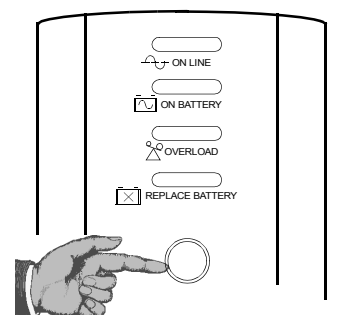

Observe that the following events occur after pressing and releasing the push-button:

- The green **On-Line** indicator flashes.
- The yellow **On Battery** indicator lights while the **Self-Test** is being performed.
- When **Self-Test** has successfully completed, only the green **On Line** indicator will be lit.
- If the internal battery is not connected, (see Step 1 above) the green **On Line** indicator will light and the red **Replace Battery** indicator will flash.

**5 Connect USB Cable and Install Software (optional)**

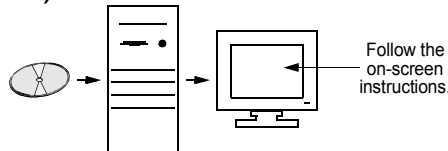
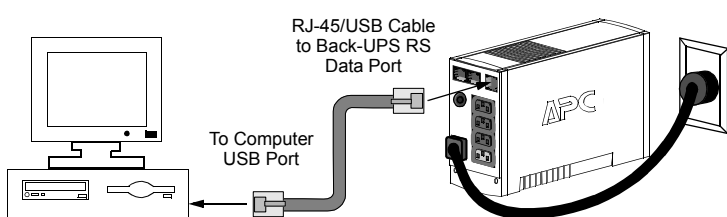

If Autoplay is not enabled on the computer, proceed as follows:

1. On the computer desktop of the display, double-click on My Computer.
2. Double-click on the CD-ROM drive icon and follow the on-screen instructions.

**Back-UPS RS Storage**

Before storing, charge the Back-UPS RS for at least eight hours. Store the Back-UPS RS covered and upright in a cool, dry location. During storage, recharge the battery in accordance with the following table:

Storage Temperature	Recharge Frequency	Charging Duration
-5 to 30°C 23 to 86°F	Every 6 months	8 Hours
30 to 45°C 86 to 113° F	Every 3 months	8 Hours

Please contact APC Online Technical Support to troubleshoot the unit before returning it to APC.

**Status Indicators and Alarms**

There are four status indicators (lights) on the front panel of the Back-UPS RS (On Line, On Battery, Overload, and Replace Battery).

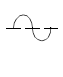
 **On Line (green)** - is lit whenever utility power is powering the Battery Backup outlets.

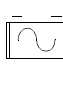
 **On Battery (yellow)** - is lit whenever the battery of the Back-UPS RS is powering equipment connected to the Battery Backup Outlets.

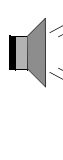
 **Continuous Beeping** - this alarm is sounded whenever a low battery condition is reached. Battery run-time is very low. Promptly save any work in progress and exit all open applications. Shutdown the operating system, computer and the Back-UPS RS.

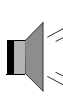
 **Four Beeps Every 30 Seconds** - this alarm is sounded whenever the Back-UPS is running On Battery. Consider saving work in progress.

 **Overload (red)** - is lit whenever power demand has exceeded the capacity of the Back-UPS RS.

 **Continuous Tone** - this alarm is sounded whenever the Battery Backup Outlets are overloaded.

 **Circuit Breaker** - the circuit breaker button located on the rear panel of the Back-UPS RS will stick out if an overload condition forces the Back-UPS RS to disconnect itself from utility power. If the button sticks out, disconnect non-essential equipment. Reset the circuit breaker by pushing the button inward.

 **Replace Battery (red)** - is lit whenever the battery is near the end of its useful life, or flash if the battery is not connected (see above). A battery that is near the end of its useful life has insufficient run-time and should be replaced.

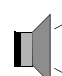
 **Chirps for 1 Minute Every 5 Hours** - this alarm is sounded whenever the battery has failed the automatic diagnostic test.

**Order Replacement Battery**

The typical battery lifetime is 3-6 years (depending on the number of discharge cycles and operating temperature). A replacement battery can be ordered over the phone from APC, or the battery can be ordered on-line from the APC web site (see below, a valid credit card is required).

When ordering, please specify Battery Cartridge **RBC2**.

