

Pulsar CT 315/5000 VA



Line Conditioners

Pulsar CT Line Conditioners are time and money savers which will help you protect your company's sensitive electronic equipment (laboratory, process control...) against power fluctuations. They monitor your power supply, avoid damage of the components of your electronic equipment. Pulsar CT guarantee service continuity that is vital for your business.

- ▶ Complete galvanic isolation
- ▶ Tight regulation and permanent filtering
- ▶ Utility line harmonic compensation

To ensure that nothing will stop you now, Pulsar CT come with a two-year warranty, the proof of a high level of reliability. With its outstanding aesthetics, Pulsar CT is the best series of today's Line Conditioners.



THE UNINTERRUPTIBLE POWER PROVIDER

MGE
UPS SYSTEMS



▶ Pulsar CT 3/6/12



▶ Pulsar CT 30/50

▶ Unmatched Performances

- > Input/Output Galvanic Isolation
- > Permanent filtering
- > Full shortcircuit-proof
- > Tight regulation
- > Harmonic reduction
- > Microbreak Protection (< 20 ms)

▶ Ease of integration

- > Compact
- > Outstanding aesthetics
- > USE or DIN Output Receptacles (CT 3/6/12)
- > Front panel display
- > Alarms (CT 30/50)

▶ Complete galvanic isolation

Your power supply is permanently protected, even against a 4,000 volt transient surge due to lightning! This kind of performances is the sign of a real high-end product.

▶ Tight regulation and permanent filtering

Whatever the voltage fluctuations you may get, Pulsar CT will permanently regulate the line within a 3 to 5 percent window.

▶ Utility line harmonic compensation

Like Pulsar EX or SineWave for higher power ratings, Pulsar CT reduce harmonics regenerated on the utility by the load, enhancing the customer global power quality.

▶ User Interface and connections

Pulsar CT 3/6/12

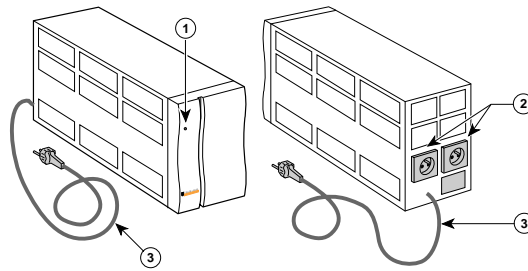

- 1 - Voltage indicator
- 2 - 2 output receptacles
- 3 - Input cord

▶ USE outlets



▶ DIN outlets



Pulsar CT 30/50

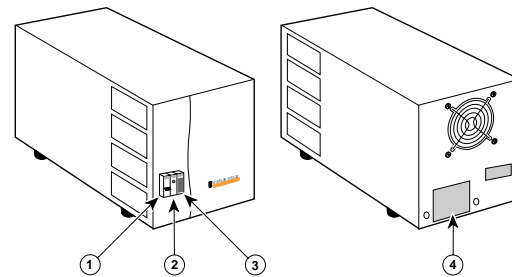

- 1 - On / Off circuit breaker
- 2 - Voltage indicator
- 3 - Air flow and temperature Alarm
- 4 - Input / Output terminal block

▶ Principales caractéristiques

Pulsar	CT 3	CT 6	CT 12	CT 30	CT50
General					
Power VA/W	315/250	625/500	250/1000	3000/2400	5000/4000
Dimensions H x W x D (in mm)	253X172X400	253X172X400	253X172X400	293X300X500	293x300x500
Weight (in kg)	10	15	25	40	51
Technical specifications					
Input voltage	230 V +/- 20 %				
Output voltage	230 V +/- 5 % (+/- 3 % for input voltage) 230 V +/- 15 %				
Frequency	50Hz				
Earthing system	Earthed neutral (disconnectable)				
THD	< 3 % at rated linear load				
Connections					
Input Connection	1 cord + earthed plug			Terminal block	Terminal block
Output Connection	2 USE or DIN outlets (model dependent)			Terminal block	
Standards					
EMC	EN 50 091 - 2 and 50 022/11 - B				
Susceptibility	EN 50 091 - 2 and IEC 1000 - 4 - 2 to 1000 - 4 - 5				
Safety	IEC 950/EN 60 950/EN 50 091 - 1				
Environment					
Response time	30 ms				
Temperatures thresholds	- 10° C, + 40° C				
Indice de protection	IP 20				
Sevices associé					
Warranty (country dependant)	2 years				